



COMPANY PROFILE

WELCOME TO **FRONTLINE** CONTRACTING

PREAMBLE

Frontline Contracting (PBC) is the name behind many of the Zimbabwe's most advanced and prestigious facilities through its founders who have been in the industry for more than ten years. We provide our clients with reliable solutions to their most complex construction challenges. Frontline is recognized as a leader in the industry for its strength in traditional construction methods and for its creative, fresh approach and cutting-edge delivery technologies. Our expertise spans the construction industry spectrum, from smaller renovations to multi-million dollar projects. We specialize in civil works, earthworks, construction of residential, educational, healthcare and industrial facilities; telecommunications and data centers, as well as infrastructural developmental projects such as roads, water and wastewater treatment plants among a host of other projects.



BACKGROUND

Our success is driven by our promise to deliver quality projects safely on time and within budget. We are known for building the most advanced facilities for our individual, corporate, institutional and government clients. More and more of clients are turning to us for our distinctive ability to implement innovative project management techniques and to serve as a reliable provider of knowledge-driven solutions for their complex construction projects. Our team of construction professionals offers a single- source solution for all of your construction-related needs. Whether its restoration, site preparation, a new facility or facility renovation, we have the experience and personnel to provide the highest quality construction on schedule and within budget. We support our clients from project inception, to the commissioning of the fully operational facility. And our network of local offices enables us to offer our clients the dual advantage of a strong local presence and broad geographic reach.



HOW WE **OPERATE**

PRECONSTRUCTION SERVICES

We work with the owner and the design team in the early phase of drawings, to provide value engineering and suggestions for siting, constructability, budget and scheduling. Within our Preconstruction services, we act as a value-added member of the design team, enhancing the design segment of the job by providing accurate pricing information and marrying the budget to the actual design. By incorporating items such as sustainability and maintenance costs into our design review, our suggestions can often save the owner money well into the future. Our pre-construction team works to reduce the overall project cost by saving time, labor and expenses. The result is a building designed to the owner's specifications, within budget and with no surprises.

GENERAL CONTRACTOR

As a General Contractor, our services begin with pricing. We bid out the job in predetermined packages, and verify the validity of the bids using our extensive cost histories. During actual construction, we manage the day to day activity on the job, including safety, quality control and adherence to the schedule. We also provide bonding for the project and hold all subcontractor contracts, unless instructed to do otherwise by the owner. We have the ability to self-perform many aspects of our work, giving us greater control over the schedule and allowing us to truly drive the project. Our expertise also extends to Design-Build Construction. After first examining the specifications of the owner, we team with a design firm that has extensive experience in similar projects. This Design-Build team then acts as a cohesive unit

STRATEGIC PARTNER

As a Strategic Construction Partner, we operate as an extension of our client's own staff, overseeing both project construction and facilities management. Within this role, we create a "construction program" in which we manage design review, budgeting, scheduling, quality control, safety, and security, as well as any other client requested items. This project delivery method is best suited for an organization with multiple projects or facilities because it provides a consistent, measurable program through every phase of the construction process which can be extended to any location or facility. Frontline's culture is one of collaboration and cooperation. This culture provides us with the ability to listen to our clients, subcontractors and vendors in an effort to discover the best means possible to provide the team with an outstanding construction experience. This ability to listen enables us to maintain successful working relationships with clients, subcontractors and vendors while implementing cutting-edge technology on our projects.

CAPABILITY STATEMENT

Frontline Contracting is a commercial and residential company that performs renovations, painting, remodeling, civil works and facilities maintenance in Zimbabwe.

Since 2014, we have performed for Old Mutual Properties, City Councils, Property Managers, Commercial Retailers and numerous home owners in the most professional and effective manner, turning in projects on time and on budget. Our core capabilities are self-performing, rough and finished carpentry, boundary walls, painting, flooring, tiling, installations and electrical works, and providing general contracting services for medium to large size projects.



OUR POLICIES



EMPOWERMENT

Frontline Contracting is committed to developing and maintaining substantial opportunity and participation for minority, women and disabled veterans' business enterprises. Our team is committed to utilizing our resources to identify and work with as many qualified and capable minority and disadvantaged subcontractors and suppliers as possible.

SAFETY

Safety; the only way to work! That is the motto by which we live. We are committed to safety above all else, and this commitment is central to everything we do. No task is so important that we cannot find a safe way to do it.



CULTURE

Frontline contracting's corporate culture is practised by the entire workforce and contributes significantly to the satisfaction of our employees and our success on the market. Our corporate culture defines the basic principles, objectives and values of our actions.

ENVIRONMENT

The company is committed to having a minimum impact on the environment through the structures it constructs and the methods it employs to deliver the project. We strive to cater for all our energy needs through renewables.

Our safety, health and environment (SHE) policy is guided by ISO 14001:2004 and OHSAS 18001:2007 management systems and Centre on a zero-harm philosophy towards people, host communities and the environment.



SUSTAINABILITY

Giving back to the communities in which we work has been a long-standing tradition with the company. We get involved by providing donations of our time, money, materials and expertise. We organize group opportunities with different causes and charities and encourage employees to volunteer in our community.

QUALITY

Our work meets the most rigorous quality standards but yet is priced competitively.



MISSION

To safely deliver construction projects that build the benchmark of quality for the benefit of our clients, shareholders, employees and the communities we serve.

OUR MISSION DEFINES WHAT WE SET OUT TO DO EACH DAY.

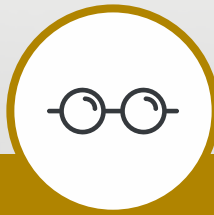

VISION

Our vision reminds each of us of what we should be striving for each day and where we ultimately want to be as a company.

TO BE A LEADING INTERNATIONAL CONSTRUCTION COMPANY BY SAFELY AND CONSISTENTLY DELIVERING QUALITY AND INNOVATIVE PROJECTS AND SERVICES.



VALUES

- Resourcefulness
- Viability
- Client Satisfaction
- Inclusivity and Diversity
- Innovation
- Social Responsibility
- Relationships

MARKET POSITIONING STATEMENT

For individual, corporate, institutional and government clients, Frontline Contracting will prove to be the contractor of choice due to our creative, fresh and cutting edge approach. Frontline Contracting is recognized as a leader in the industry for its strength in traditional construction methods and the distinctive ability to implement innovative project management techniques. Our mission, as Frontline Contracting, promises deliver safe and quality construction projects that best satisfies our customers' needs.

INTEGRITY

We do the right thing for our clients and employees. We do what we say.

Resourcefulness

We are a can-do, get-it-done company.

VIABILITY

We provide great value for a fair return. We strategically re-invest our profits to maintain operational excellence and grow shareholder value.

CLIENT SATISFACTION

We listen, we build trusting relationships and we stand behind our work.

INCLUSIVITY AND DIVERSITY

We are dedicated to being top-of-class in providing mentoring and growth opportunities to emerging and marginalized firms and entrepreneurs.

INNOVATION

We collaborate to find the best way and deliver the highest expertise.

SOCIAL RESPONSIBILITY

We are committed to the community, environment and our employees.

RELATIONSHIPS

We have an open relationship with our employees based on mutual trust, respect and success



KEY PERSONNEL

TAMUKA CHIHOTA
MANAGING DIRECTOR



Tamuka holds a BSc Honors Psychology Degree from the University of Zimbabwe, a diploma in Payroll Administration and Personnel Management. Tamuka has worked for various companies in the Human Resources Department including Al-Accard group of companies in Dubai for over 6 years. Tamuka holds the much needed experience necessary to lead Frontline Contracting Company. Tamuka is responsible for leading the implementation of the company strategy as well as to mobilize resources for the organization.

MANDLA MASUNDULWANE
MARKETING MANAGER



Mandla is a holder of Bachelor's degree Marketing acquired from Midlands State University. He is a results oriented marketer with broad experience and proven record in consistently and effectively delivering marketing services that help to enhance the company cash flows. He is therefore the custodian of organizational growth and also ensures that clients are utilized sufficiently towards all the projects-current and past. His services have brought positive results for the company.

TANATSA PIKI
STRUCTURAL ENGINEER



Tanatsa holds a National Diploma in Civil and Structural Engineering. He is a young vibrant man with innovative prowess and has been involved in huge construction sites as a technician. He has mastered the art of designing structures and is currently working towards being a member of the Zimbabwe Institute of Engineers

DUMISANI R KHESWA L.N
QUANTITY SURVEYOR



Dumisani holds a diploma in Quantity Surveying from Harare Polytechnic and a National certificate in Project Management. Dumisani is responsible for coming up with bills of quantities, cost effective solutions and overall project day to day management. He gained invaluable experience during his attachment stint by being attached to one of the biggest institutions nationally – Ministry of Transport and Infrastructure and the Ministry of Housing and Public Works. This invaluable experience has been handy for Frontline and more so to our clients.

GEORGE T MADZIVA
Site Manager



George holds a diploma in Civil Engineering from Mutare Polytechnic. George has more than 3 years working experience as a resident engineer for various companies including Ruwa Local Board. George is responsible for ensuring that client's needs and expectations are met qualitatively and timeously. He has more than three years' experience in roads engineering, water and sewer designing and structural engineering designing to mention but a few.

ABRAHAM NJIRI
BUSINESS DEVELOPMENT
MANAGER



Abraham is a holder of marketing and sales management Diploma from the UK college of professional management. He also holds a certificate in entrepreneurship course with Empretec Zimbabwe in conjunction with Delta Corp Zimbabwe and another certificate in Security and risk management supervision course with Speciss College. Abraham has had vast experience in the field working under reputable companies like ZUPCO, Moonlight Funeral Services and Golden Knot Group just to mention a few.



FARAI MAZHANDU
OPERATIONS DIRECTOR

Farai holds a BSc Honors Physics Degree from the National University of Science & Technology (NUST). Farai cut his teeth at Zisco steel as a graduate trainee. Farai has demonstrated his leadership abilities to the utmost satisfaction of the whole Frontline Team. Farai has worked as a teacher for various private colleges in Kwekwe and has been running small businesses in his spare time and it is in these small businesses that he has demonstrated his leadership abilities and business acumen- a vital skill needed to run Frontline Contracting. Farai is responsible for the day to day leading role in the team and ensuring that all strategic issues are attended to while simultaneously implementing the overall company objectives and strategies. Farai drives the Frontline engine team towards the company vision.



TINOTENDA MUSONZA
ARCHITECTURAL TECHNOLOGIST

Tinotenda holds a diploma in Architectural Technology with Harare Polytechnic.

He worked with the Harare City Council, as an intern in City Architect Department with the *City Architect* Tinotenda was involved in many projects these include designing of Schools, Clinics and also the Bus Terminus. Tinotenda was also involved in the site inspection of the the council buildings (ie Clerk of works).

He Worked for the Mamsen Engineering as Draughtsman ,Tripple Jewel Consultant under Arch, Chombe as an Architectural Tech and With TJC he was involved in the designing, drafting and rendering residential and commercial projects. Projects done under TJC : Residential houses, Subdivision, Interior Designs Industrial Buildings and Cluster Houses.

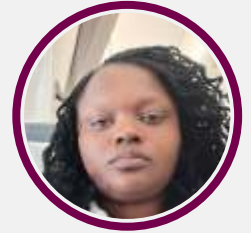

MELODY DHLIWAYO
Finance Manager

Melody is a holder of a certificate in business management (SA), Bcom Accounting (MSU), Mcom Accounting (MSU) Melody is also a member of CIMA. She is a results oriented accountant with broad experience and proven record in consistently and effectively delivering accounting services that help to enhance the company cash flows. She is therefore the custodian of organizational funds and also ensures that client's funds are utilized sufficiently towards all the projects-current and past. Melody is also experienced in publishing, IT, Tobacco and Construction.



GUYSON MUPARA
SAFETY AND HEALTH OFFICER

Guyson is an experienced Environmentalist with hands on experience in Safety, Health and Environmental Management and integrated waste management. He has profound knowledge of the numerous International Standards (ISO 14001, ISO 9001 and OSHAS 18001) and the national regulations for Occupational Health, Safety and Environmental Management Systems (Factories and Works Act of 1976 and Environmental Management Act of 2003). Guyson ensures that we adhere to all the local and international policies regarding environmental sustainability. He is responsible for policy formulation, safety of the employees on site as well as ensuring that all the materials used on site meet all the approved standard requirements. He also ensures that all compliance issues regarding safety, health and welfare of employees are given utmost attention.y as well as to mobilize resources



ENG. DUMOLUHLE DUBE
 PROJECTS MANAGER

Dumoluhle Dube holds a Bachelor Honours Degree in Civil Engineering from the University of Zimbabwe. Dumoluhle has more than 3 years working experience as a projects manager for various companies which include Big Nyati Trust Construction and 2 years at Group Five International as a resident engineer. Being a well-travelled engineer, Dumoluhle has been exposed to water, structural and roads engineering. He has exposure and experience shall be the benchmark upon which all Frontline Contracting projects shall be premised. He is also conversant with Safety, Health, Quality Assurance and Business Management Policy (BMS). Dumoluhle is responsible for the management of all Frontline Contracting projects, ensuring that projects are executed timeously, economically, and adhere to all building construction standards enshrined in the Zimbabwe Building Construction by Laws.



STEPHEN RUPIYA
 CHIEF ENGINEER – ENG.

Stephen holds a Bsc Honors Degree from the University of Zimbabwe (UZ). Stephen is an experienced Professionally Registered Professional in the Civil, Construction and Engineering Infrastructures with 20 years of continuous engagement and excelled at various posts of the industry excelling and promoting the Technical requirements of the Company with a proven experience throughout the region and Continent at large.



PROJECTS THAT WE HAVE DONE

PROJECT : CONSTRUCTION OF HARD STAND
SITE : ZESA CHEGUTU 88 KV SUB-STATION
CLIENT : ZESA ENT
CONTACTS : Eng. S MUDEHWE
Email : smudehwe@zent.co.zw
Cell : +263773 596 495
Tel : (024) 661216/666710/666787

PROJECT : ROAD CONSTRUCTION TO BASE 1
SITE : NYATSIME AREA
CLIENT : MAPINDUZI HOUSING CO-OP
CONTACTS : Ms. E NCUBE/Mr. S MAPAKO
Email : draykln88@gmail.com
Cell : +263 772 258 962/0772 526 256

PROJECT : BRIDGE CONSTRUCTION LINKING
SITE : CHITUNGWIZA- NYATSIME AREA
CLIENT : MAPINDUZI HOUSING CO-OP
CONTACTS : Ms. E NCUBE/Mr. S MAPAKO
Email : draykln88@gmail.com
Cell : +263 772 258 962/0772 526 256

PROJECT : ROAD CONSTRUCTION AND EARTHWORKS
SITE : ZRP CONSE
CLIENT : ZIMBABWE REPUBLIC POLICE
CONTACTS : Insp MUGUGUNYEKI
Email : consec2020@gmail.com
Cell : +263 717 226 090
Tel : (024) 225 0721

PROJECT : ROAD POTHOLE PATCHING
SITE : GMB SAMORA DEPOT
CLIENT : GRAIN MARKETING BOARD
CONTACTS : Mr. SIYAMACHIRA/ Ms. S ALUMENDA
Email : alumendas@gmbdura.co.zw
Cell : +263 782 762 968
Tel : (024) 701 875-95

PROJECT : SOLAR STREET LIGHT STRUCTURAL
SUPPORT AT 8m PEAK HEIGHT
SITE : RUWA
CLIENT : RUWA LOCAL BOARD
CONTACTS : Eng. MUJURU
Email : ruwatown@gmail.com
Cell : +263 772 722 421
Tel : 027 2638-9

PROJECT : CONSTRUCTION OF 120x 3
BEDROOMED UNITS
SITE : NYATSIME AREA
CLIENT : MAPINDUZI HOUSING CO-OP
CONTACTS : Ms. E NCUBE/Mr. S MAPAKO
Email : draykln88@gmail.com
Cell : +263 772 258 962/0772 526 256

PROJECT : CONSTRUCTION OF GIRLS HOSTEL
SITE : REDCROSS COLLEGE
CLIENT : REDCROSS SOCIETY OF ZIMBABWE
CONTACTS : Mr. D MUTIKORI
Email : dmutkori@redcrosszim.org.zw
Cell : +263 772 288 462
Tel : (024) 307 241-4/332197/332638

PROJECT : CONSTRUCTION OF CONCRETE PLINTHS
SITE : MUTARE
CLIENT : NETONE ZIMBABWE
CONTACTS : Mr. K CHAMBISHA
Email : kchambisha@netone.co.zw
Cell : +263 712 980 493
Tel : (024) 750 607

PROJECT : Graveling of 1km Road
CLIENT : RAHA CANGROW
CONTACTS : Mr A Gupta
Email : a.gupta@cangrow.co.zw
Cell : +263 782 793 9660

PROJECT : Branch Paving
CLIENT : OLD MUTUAL-Kwekwe
CONTACTS : Ms R Muzarakuza
Email : MuzarakuzaRumbidzayi@oldmutual.co.zw
Tel : +0242 332 646-53

PROJECT : Chinhoyi Depot Refurbishment
CLIENT : ZUVA PETROLEUM
CONTACTS : Mr H Matamande
Email : handsomem@zuvapetroleum.co.zw
Cell : +263 779 800 367

An aerial photograph of the New York City skyline, featuring the Empire State Building prominently in the center. The image is overlaid with a large, dark red, semi-transparent geometric shape on the left side, which contains the text. Additionally, several white, semi-transparent geometric shapes, including triangles and parallelograms, are layered over the right side of the image, creating a modern, architectural feel. A yellow chevron shape is partially visible on the far left edge.

OUR PORTFOLIO

ARCHITECTURAL & STRUCTURAL DRAWINGS



CIVIL WORKS



BUILDING CONSTRUCTION



RENOVATIONS



PLANT AND EQUIPMENT HIRE



STEEL STRUCTURES

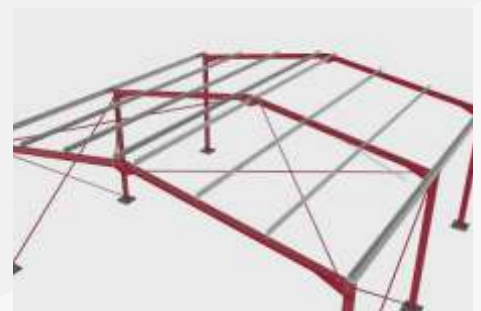



Our expertise spans the construction industry spectrum, from smaller renovations to multi-million dollar projects. We specialize in civil works, earthworks, construction of residential, educational, healthcare and industrial facilities.





9th Floor Bard House,
69 Samora Machel Ave
Harare, Zimbabwe



+263 242 797 241/3



+263 715 887 199 | +263 772 915 561
+263 714 755 022 | +263 734 176 488



info@fontlinecontracting.net



www.frontlinecontracting.net



/fontlinecontracting



@frontlineworks